

# TurboDock™ Charger

Model 120/240V

## User's Quick-Start Charging Guide

Before you can charge your vehicle:

- Download and install TurboDock app to your Bluetooth LE (Low Energy)-capable smartphone. (iPhone 4S or newer, Android 4.3 or newer)
- Know your 4-digit PIN assigned by the Account Manager.



### TURBODOCK COMPONENTS

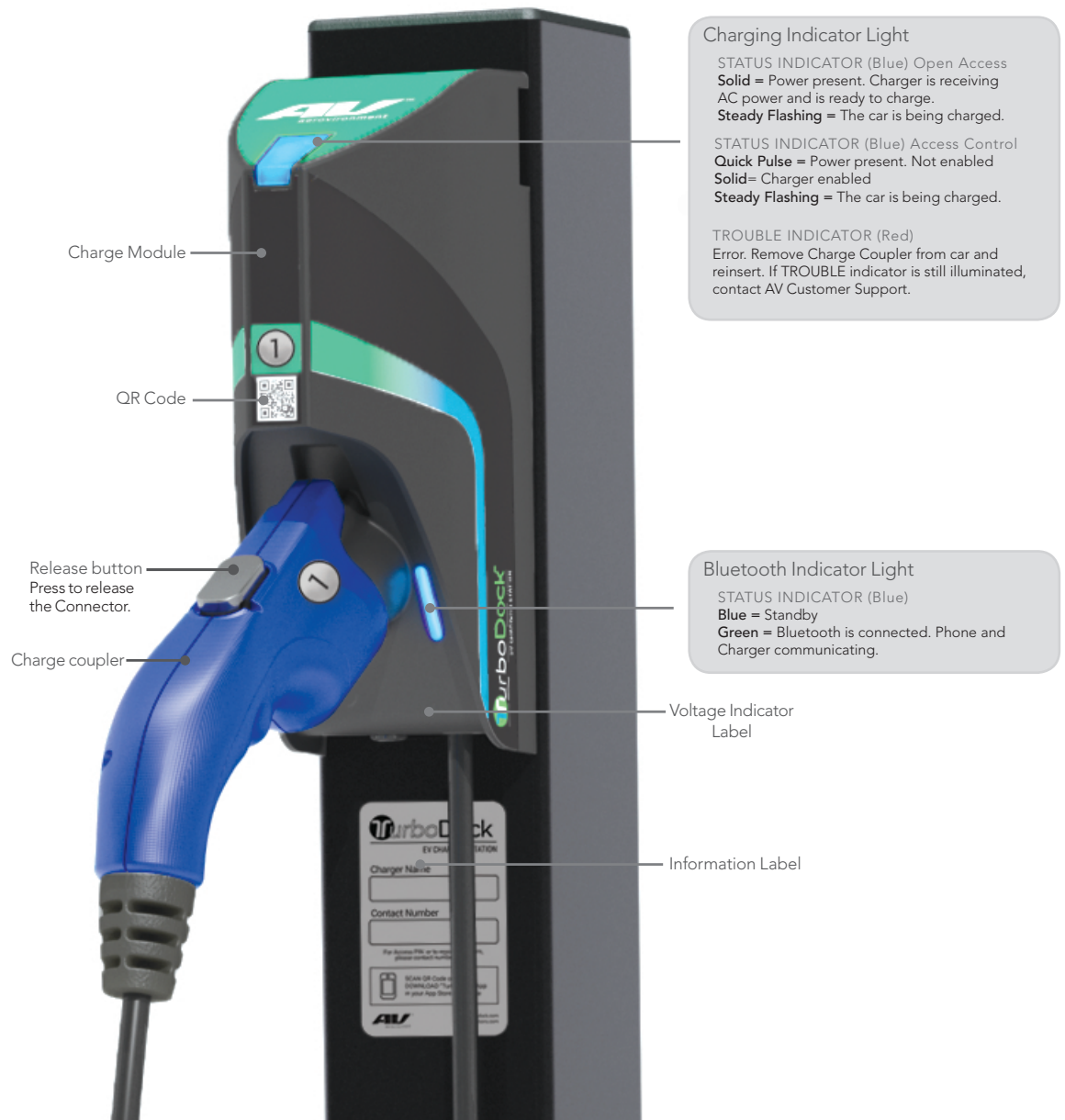

**Charging Indicator Light**

STATUS INDICATOR (Blue) Open Access  
**Solid** = Power present. Charger is receiving AC power and is ready to charge.  
**Steady Flashing** = The car is being charged.

STATUS INDICATOR (Blue) Access Control  
**Quick Pulse** = Power present. Not enabled  
**Solid** = Charger enabled  
**Steady Flashing** = The car is being charged.

TROUBLE INDICATOR (Red)  
Error. Remove Charge Coupler from car and reinsert. If TROUBLE indicator is still illuminated, contact AV Customer Support.

**Bluetooth Indicator Light**

STATUS INDICATOR (Blue)  
**Blue** = Standby  
**Green** = Bluetooth is connected. Phone and Charger communicating.

Prototype image shown. Production model may vary.



# Quick Start Guide

1

Before you start make sure that:

- The car is in PARK and turned OFF
- The CHARGER COUPLER you wish to use is plugged into the TurboDock Receptical; otherwise it will not enable. The BLUE STATUS Indicator on top of the CHARGE MODULE should be in "standby" mode (flashing quickly, twice per second).
- Your smartphone's Bluetooth is "ON".
- You know the 4-digit PIN. \*If you lose or forget it, contact your Account Manager.



2

Launch the app on your smartphone.

It will scan for all nearby chargers and display them in the "Select Available Charger" screen.

Select an available charger by tapping it.

An information label with the name of the charge module may be placed above or below the Charger Module.

Chargers that are in use or disabled are not selectable.



3

When the connection is made.

The "Bluetooth" indicator lights will turn green.

Enter Your PIN.

Your first time using this charger, you'll see the "Enter PIN" screen. Enter your 4-digit PIN on the screen.

You'll be taken to the "Ready to Charge" screen.

\*If you exit the app or leave Bluetooth range, the lights will change from GREEN to BLUE. You will have the 1 minute to start charging your vehicle.

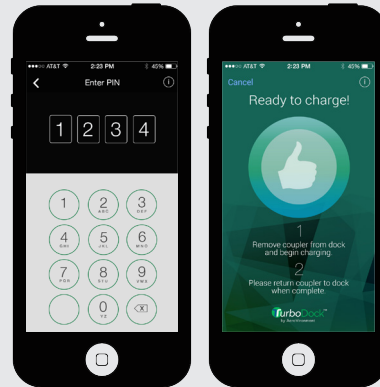

4

Plug the CHARGE COUPLER into your vehicle's charging outlet until it clicks.

**Automatic charging will begin.** Power will be delivered according to vehicle demand. While the vehicle is charging, the BLUE STATUS Indicator will blink "ON" and "OFF" approximately every two seconds. \*Verify that your vehicle's charging status indicator agrees.

**When fully charged,** the BLUE STATUS light will turn solid blue.

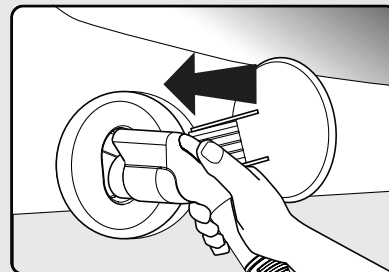

Charge Smarter. Drive Farther.™  
To download the full user guide go to [www.turbodock.com](http://www.turbodock.com)

**For assistance, call (888) 833-2148.**

# Quick Start Guide

**5**

Once charging is complete:

Disconnect the CHARGE COUPLER by pressing the release button and removing it from the vehicle. The charger will shut off, and the BLUE STATUS indicator will flash quickly ("standby").

\*Please remember to reinsert the COUPLER into the TurboDock and the cable on the Cable Hanger after the charge is complete.

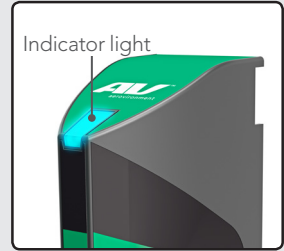
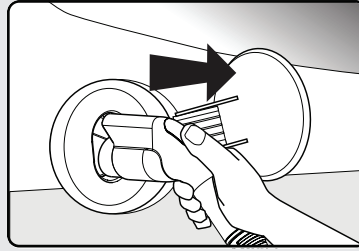

## **\*\*Manual Stop\*\***

To safely stop charging at any time before charge completion, just press the CHARGE COUPLER release button and remove it from the vehicle.

Charging will automatically and safely stop.

The charger will return to the standby state (the BLUE STATUS light flashing quickly) when the coupler is removed from the vehicle. Please remember to replace the coupler into its port.

To resume charging, you must reconnect using the smartphone app. The COUPLER must be in its port on the CHARGE MODULE before you can reconnect the charger.



## **WARNING!**

IMPORTANT SAFETY INSTRUCTIONS. SAVE THESE INSTRUCTIONS:

When using electric products, basic precaution should always be followed, including the following:

- Read warnings on Charger cord label before operating Charger for the first time. Read all instructions in the User Guide before using Charger.
- Children should be supervised when in the vicinity of Charger and while Charger is plugged in.
- DO NOT put fingers into the electric charge coupler.
- DO NOT use Charger if the flexible power cord, charge coupler, or Charger are broken, cracked, open, or show any indication of damage.
- ALWAYS position Charger and cable so that they will not be driven over, stepped on, tripped over, or otherwise damaged while in use.
- To minimize risk of personal injury, Replace Charger in Charge Module after use.
- Maximum operating temperature 70°C (158°F).
- Not for use in a commercial garage.
- For use with a grounded circuit.

Charge Smarter. Drive Farther.™  
To download the full user guide go to [www.turbodock.com](http://www.turbodock.com)

**For assistance, call (888) 833-2148.**

